

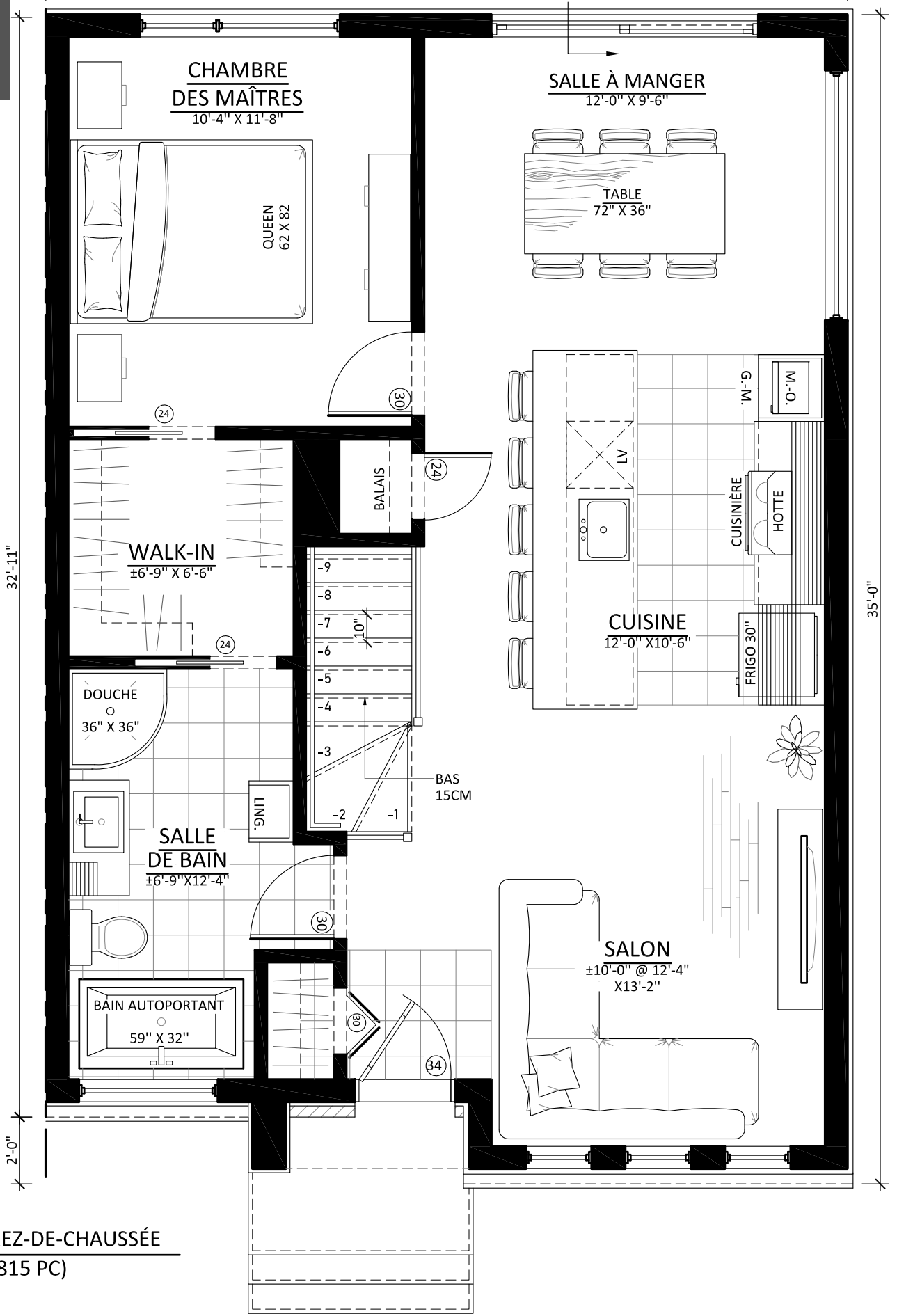

Les Constructions  
**Reno Plourde**  
 Entrepreneur général  
 Construction | Renovation

# LIVIA

24'-0"



32'-11"

35'-0"

2'-0"

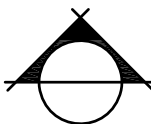

REZ-DE-CHAUSSÉE  
 (815 PC)



Les Constructions  
**Reno Plourde** Inc.  
Entrepreneur général  
Construction | Renovation

# LIVIA

24'-0"

33'-0"

2'-0"

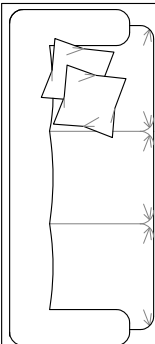

**VIVOIR**  
±10'-2" X 12'-6"

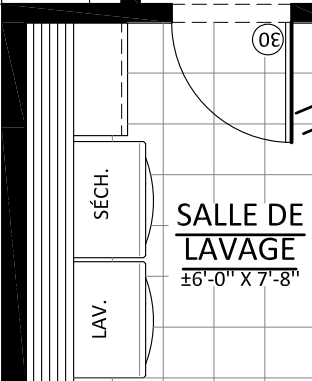
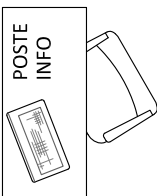

**SALLE DE LAVAGE**  
±6'-0" X 7'-8"



**MÉCANIQUE / RANGEMENT**  
6'-6" X 6'-10"

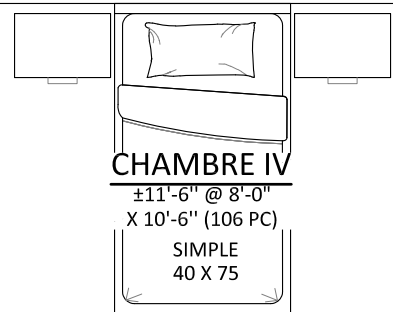
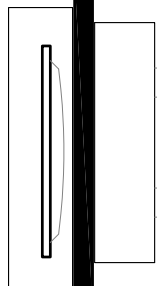
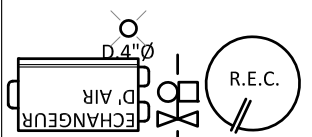

**CHAMBRE IV**  
±11'-6" @ 8'-0"  
X 10'-6" (106 PC)  
SIMPLE  
40 X 75

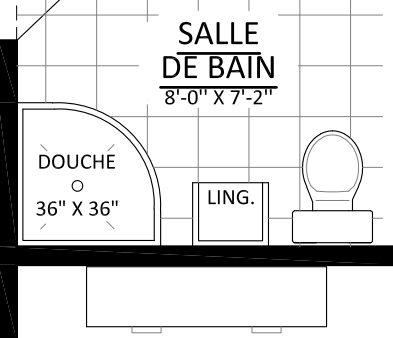
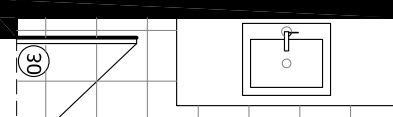
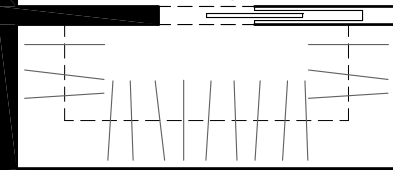
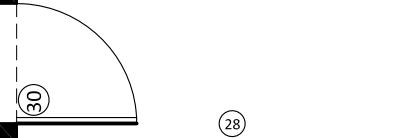

**CHAMBRE II**  
±11'-6" X 11'-0"

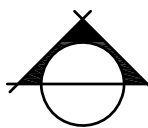
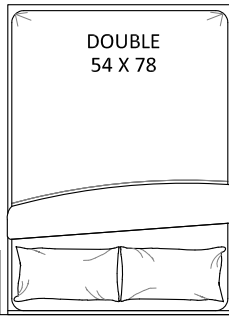

**SOUS-SOL**  
(815 PC)

P.E.

-15  
-14  
-12  
-11  
-10  
-9  
-8

08

08

30

24

30

28

30

30

30

24